

ITEM NO.	NAME & Part No.	QTY.	Assembly instructions	Material
1	GWR 14XX - part A43 - frames assembly - part 4	1	See assembly instructions.	various
2	GWR 14XX - part A83 - boiler exterior assembly	1	Cut and fit the ceramic insulation to the boiler – see the pattern on the smokebox page. Fit the completed boiler cladding over the boiler , the smokebox rear ring and the insulation. Clamp the bottom of the boiler with 2 x 12BA bolts through the bottom holes. Stop the cladding from rotating by applying some gunge to the smokebox rear ring when fitting – it may need to come off in future.	various
3	GWR 14XX - part A63 - footplate assembly	1	See assembly instructions. Fix to the buffer beams by inserting the buffers.	various
4	GWR 14XX - part A67 - cab interior assembly	1	See assembly instructions. Fix to the frame with 2 x 8BA Csk screws.	various
5	GWR 14XX - part A69 - Bunker assembly	1	See the assembly instructions. Fix to the running plate with 4 x 8BA screws from below.	Brass and nickel silver
6	GWR 14XX - part A79 - tanks assembly	1	See the assembly instructions. Fix to the running plates/valances with 4 x 8BA screws inserted from below.	various
7	GWR 14XX - part A81 - cab assembly	1	See the assembly instructions. Clips into the tanks and the bunker.	Nickel silver
8	14XX - top feed injector pipe assembly	1	Fitted to some locos only as later modifications. Bend a 4.1" (104.5mm) length of 1/16" diameter brass rod to the shape shown. You may want to make it longer at the front end to go further into the top feed casting, but this may make disassembly more difficult. Similarly at the rear – the cab front has holes half etched into the rear face of the front spectacle plate – these could be drilled through. In practice it should be enough to just butt the rear end of this up to the spectacle plate. There are etched parts for the connector flange fitted 1.04" from the spectacle plate. These are made up from 2 parts fixed back-to-back with a tab on the bottom that goes into the tank tap – solder together. This is the only fixed attachment to the tanks.	Brass and nickel silver
9	Mirror14XX - top feed injector pipe assembly	1		

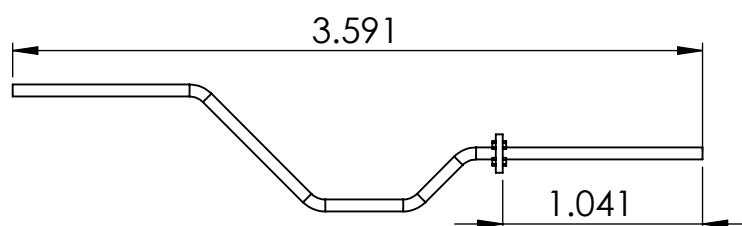

Top feed injector pipe - full size.

This assembly stage is identical for both ARM1G and OSM versions

[GWR 14XX 0-4-2T - assembly - part A01 - assembly](#)

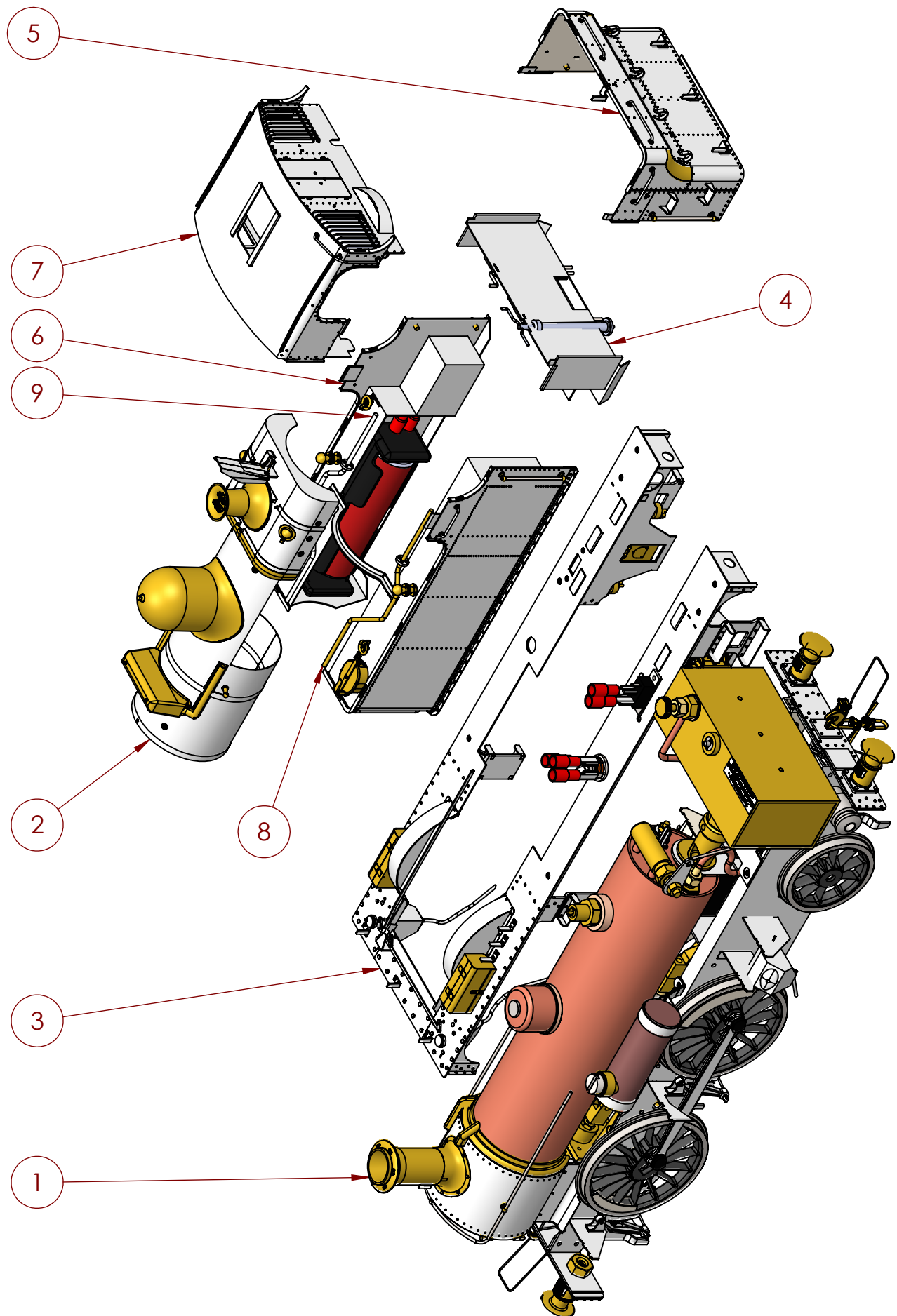

GWR 14XX 0-4-2T - assembly - part A01 - assembly